

ADVERTISED

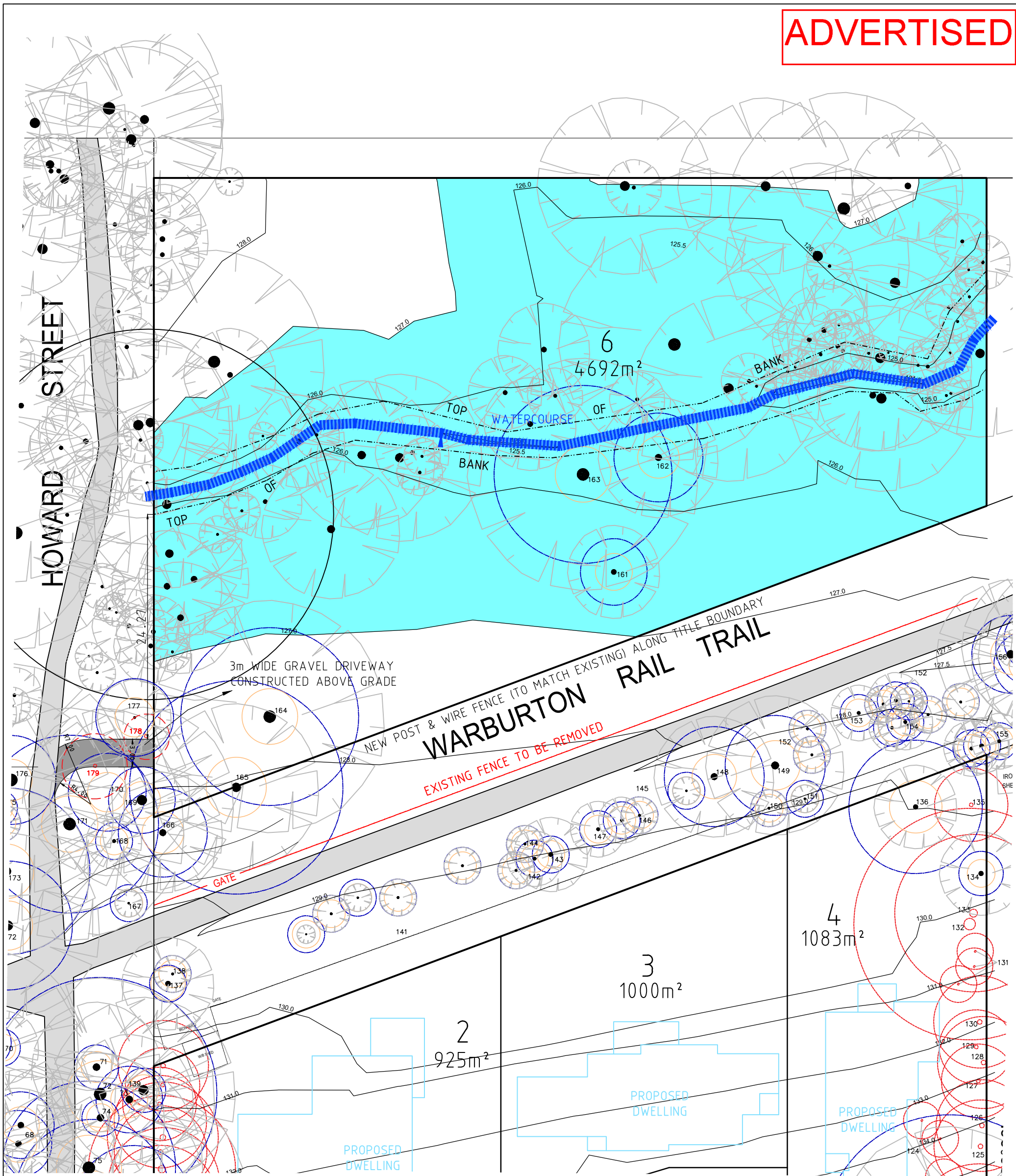

 TREE TO BE REMOVED
SEE ARBORIST REPORT
BY THE ENGLISH GARDENER
UPDATED 5TH FEB 2023.

 LAND COVERED BY THE
LAND SUBJECT TO INUNDATION OVERLAY

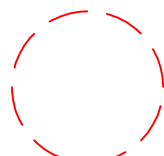
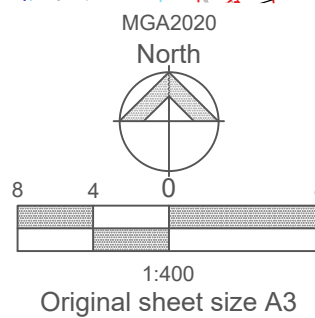

Millar & Merrigan authorize the use of this drawing only for the purpose described by the status stamp shown below. This drawing should be read in conjunction with all relevant contracts, specifications, reports & drawings.
© Millar & Merrigan Pty. Ltd.

Millar | Merrigan

Land Development Consultants

Civil Engineering
Land Surveying
Landscape Architecture
Project Management
Town Planning
Urban Design
SAI GLOBAL Quality ISO 9001

Millar & Merrigan Pty Ltd ACN 005 541 668
Metro 2/126 Merrindale Drive, Croydon 3136
Regional 156 Commercial Road, Morwell 3840
Mail PO Box 247 Croydon, Victoria 3136
M(03) 8720 9500 R(03) 5134 8611
www.millarmerrigan.com.au
survey@millarmerrigan.com.au

PROPOSED DRIVEWAY PLAN

5 SEYMOUR STREET
SEVILLE
YARRA RANGES COUNCIL

26538P3
VERSION 5
SHEET 1 OF 1

FOR APPROVAL